

**City of Glendora – Engineering Division**

**DRAINAGE PLAN / S.W.P.P.P.**

**Basic Format Requirements for non “Engineered Plan”  
(Applies to pool construction also)**

1. Submit 2 copies of plan and pay \$307 plan check fee at the Public Works Dept. counter. Plan must be legible and neatly drawn in either engineer’s scale (1” = 10’) or architect’s scale (1/8”). Sheet size can be 18” x 24” minimum or 24” x 36” maximum, with a **standard City title block in the lower right hand corner**. Include all owner, engineer, architect/drafting service, etc. or contractor contact information on the plan. Provide north arrow and small vicinity map on plan.
2. Provide Storm Water Pollution Prevention Plan (SWPPP) information on this plan. For more information on required “Best Management Practices” (BMPs) for construction sites under 1-acre regarding erosion control and construction related run-off, waster water management, containment and treatment, please visit the California Stormwater Quality Association’s website online at [www.cabmphandbooks.com](http://www.cabmphandbooks.com). The individual BMPs can be downloaded using free Adobe software.
3. Include existing topographical features with elevations (not architectural side view), structures, trees, driveways, sidewalks, street improvements, alleyways, easements, utilities, etc. Include as much detail as possible.
4. Show all proposed improvements with sections and details where necessary (i.e. retaining walls, etc.). Show all drainage patterns with elevations and detail all drainage structures (i.e. roof drains, area drains, drain lines, etc.) and identify if any water enters the property from off site.
5. **Show “Spot” existing elevations into neighboring properties for a minimum of 15’.**
6. A temporary bench mark can be used. Indicate where it is on the plan. Label as temporary bench mark and indicate assumed elevation, usually at street or lowest corner of property.
7. If requested, provide earthwork calculations for both cut and fill, in particular if the work includes any retaining walls (above 36”) directly to Public Works – Engineering. Retaining walls require a separate permit application including structural calculations and plans submitted to the Building Division. Earthwork over 50 cubic yards may require an engineered grading plan. Pool cavity is not included in earthwork calculations.
8. Provide legend of used symbols, for example:

T.C.	Top of Curb
F.L.	Flow Line
F.S.	Finish Surface
F.G.	Finish Grade
(999.00)	Existing Elevation
999.00	Proposed Elevation

Drainage pattern typically shown w/ arrows:

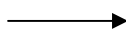

Sheet Flow / Concentrated Flow

9. Any proposed improvements in the street or alley right-of-way shall be shown and detailed (such as new parkway drains, driveways, sidewalks, water services, etc.) If project requires a new water service and meter, it cannot be located within the driveway approach.

**City of Glendora – Engineering Division**

**DRAINAGE PLAN / S.W.P.P.P.**

**Basic Format Requirements for non “Engineered Plan”**

**(Applies to pool construction also)**

The following information must be included on the plan and is usually the property owner in the case of an already developed property. In all other cases requiring new development and grading plans the SWPPP/NPDES contact:

I do hereby certify under penalty of law that this document and all attachments will be carried out under my direction and supervision. I understand that at the conclusion of this project, I will be required to submit certification that all elements of this project were carried out in accordance with this SWPPP (and all attachments). In case of emergency or SWPPP corrections contact:

Name: \_\_\_\_\_ Date: \_\_\_\_\_

Title: \_\_\_\_\_ Phone: \_\_\_\_\_

**PLEASE USE THIS VERSION OF THE CITY TITLE BLOCK IN **BOTTOM RIGHT** CORNER OF THE DRAINAGE & SWPP PLANS:**

<b>CITY OF GLENDDORA</b>		<b>ENGINEERING DIVISION</b>	
REVIEWED BY:	Plan No.	Scale:	
_____	_____	Drawn by:	
ENGINEERING DIVISION	Date	Sheet	of Sheets File No.:

TITLE: “DRAINAGE / S.W.P.P.P.”  
ADDRESS

INCLUDE SITE ADDRESS AND ALL OTHER INFORMATION SUCH AS OWNER, ENGINEER, ARCHITECT OR DRAFTING SERVICE THAT PREPARED THE PLANS SOMEPLACE ON THE PLAN.

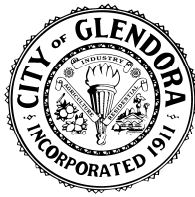

Copy Relevant Notes Only

## **STORM WATER POLLUTION PREVENTION PLAN NOTES:**

- A** ALL CONSTRUCTION MATERIALS SHALL BE DELIVERED AND STORED ON SITE PER BMP WM-1. USE OF THESE MATERIALS SHALL BE AS PER BMP WM-2.
- B** PROVIDE A CONCRETE WASTE MANAGEMENT AND VEHICLE AND EQUIPMENT MAINTENANCE AREA PER BMP WM-8, NS-10 & NS-8.
- C** PROVIDE GRAVEL BAG BARRIER PER BMP SE-6 OR FIBER ROLL PER BMP SE-5.
- D** PROVIDE STABILIZED CONSTRUCTION ENTRANCE/EXIT PER BMP TC-1.
- E** DEPLOY TRASH RECEPTACLES FOR PROPER CONTAINMENT OF TRASH PER BMP WM-5.
- F** PROTECT ALL DOWNSTREAM STORM DRAIN INLET PER BMP SE-10. THIS APPLIES ALSO FOR SAND STORAGE (FOR GUNITE) ON SIDEWALK OR STREET.
- G** PROPOSED LOCATION OF PORTABLE TOILET. DISCHARGE OF POLLUTANTS FROM SANITARY/SEPTIC WASTE TO STORM WATER DRAIN SHALL BE PREVENTED BY PROVIDING CONVINIENT, WELL MAINTAINED FACILITIES. REFER TO BMP WM-9 FOR METHODOLOGY.
- H** NO STOCKPILES, MATERIAL STORAGE ON THE PUBLIC RIGHT OF WAY ANYTIME DURING THE CONSTRUCTION UNLESS ALLOWED UNDER A TEMPORARY ENCROACHMENT PERMIT OBTAINED THROUGH PUBLIC WORKS.
- I** IF ANY EQUIPMENT/TRUCK/VEHICLE IS PARKED ON THE STREET OCCUPYING HALF OR MORE WIDTH OF THE LANE AND/OR DISRUPTING THE NORMAL TRAFFIC FLOW, THE CONTRACTOR WILL SUBMIT A TRAFFIC CONTROL PLAN AND GET IT APPROVED PRIOR TO START OF WORK.

## **GENERAL NOTES:**

1. THE STORM WATER POLLUTION PREVENTION PLAN SHALL REMAIN ON SITE AT ALL TIMES DURING THE CONSTRUCTION.
2. ALL EXISTING ON-SITE VEGETATED AREAS NOT TO DISTURB SHALL BE PRESERVED IN ACCORDANCE WITH BMP EC-2.
3. WIND EROSION CONTROL PER BMP WE-1 SHALL BE IMPLEMENTED ON A DAILY BASIS AS NEEDED TO KEEP DUST LEVELS TO A MINIMUM.
4. ALL EMPLOYEES AND/OR SUBCONTRACTORS ON THIS PROJECT SHALL BE TRAINED IN THE MATTERS OF HOUSEKEEPING PRACTICES AND WASTE CONTAINMENT IN ACCORDANCE WITH BMP WM-4 & WM-5.

# DRAINAGE / STORM WATER POLLUTION PREVENTION PLAN

## STORM WATER POLLUTION PREVENTION PLAN NOTES:

- A** All Construction materials shall be delivered and stored on site per BMP WM-1. Use of these materials shall be as per BMP WM-2.
- B** Provide a concrete waste management and equipment maintenance area per BMP WM-8, NS-10 & NS-8.
- C** Provide gravel bag barrier per BMP SE-6 or fiber roll per BMP SE-5
- D** Provide stabilized construction entrance/exits per BMP TC-1.
- E** Deploy trash enclosures for proper containment of trash per BMP TG-1.
- F** Protect all drains on storm drain inlet per BMP SE-10. This includes a cover and sand storage (for grime) on sidewalk or street.
- G** Proposed location of portable toilet. Discharge of pollutants from sanitary/septic waste to storm water drain shall be prevented by providing convenient, well maintained facilities. Refer to BMP WM-9 for methodology.
- H** No stockpiles, material storage on the public right of way anytime during the construction unless allowed under a temporary encroachment permit obtained through Public Works.
- I** If any equipment/Truck/Vehicle is parked on the street occupying half or more width of the lane and/or disrupting the normal traffic flow, the contractor will submit a traffic control plan and get it approved prior to start of work.

CALL PUBLIC WORKS AT (626) 914-8246 TO SCHEDULE S.W.P.P. INSPECTION PRIOR TO START OF CONSTRUCTION.

## GENERAL NOTES:

1. The STORM WATER POLLUTION PREVENTION PLAN shall remain on site at all times during construction.
2. All existing on-site vegetation are as noted to disturb shall be preserved in accordance with BMP EC-2.
3. Wind Erosion Control per BMP WE-1 shall be implemented on a daily basis as needed to keep dust levels to a minimum.
4. All employees and/or subcontractors on this project shall be trained in the matters of housekeeping practices and waste containment in accordance with BMP WM-4 & WM-5.

## LEGEND:

- T.C. TOP OF CURB
- FL. FLOW LINE
- F.S. FINISH SURFACE
- FG. FINISH GRADE
- (999.00) EXISTING ELEVATION
- 999.00 PROPOSED ELEVATION
- ~ SHEET FLOW
- CONCENTRATED FLOW

- (EC-1) SCHEDULING
- (SE-1) SILT FENCE
- (SE-5) FIBER ROLLS
- (SE-6) GRAVEL BAG BARRIER
- (SE-7) STREET SWEEPING & VACUUMING
- (SE-8) SANDBAG BARRIER
- (SE-10) STORM DRAIN INLET PROTECTION
- (WE-1) WIND EROSION CONTROL
- (TC-1) STABILIZED CONSTRUCTION ENTRANCE/EXIT

- (NS-3) PAVING AND GRINDING OPERATIONS
- (NS-8) VEHICLE & EQUIPMENT CLEANING
- (NS-10) VEHICLE & EQUIPMENT MAINTENANCE
- (NS-12) CONCRETE CURING
- (NS-13) CONCRETE FINISHING
- (WM-1) MATERIAL DELIVERY & STORAGE
- (WM-2) MATERIAL USE
- (WM-3) STOCKPILE MANAGEMENT
- (WM-8) CONCRETE WASTE MANAGEMENT
- (WM-9) SANITARY / SEPTIC WASTE MANAGEMENT

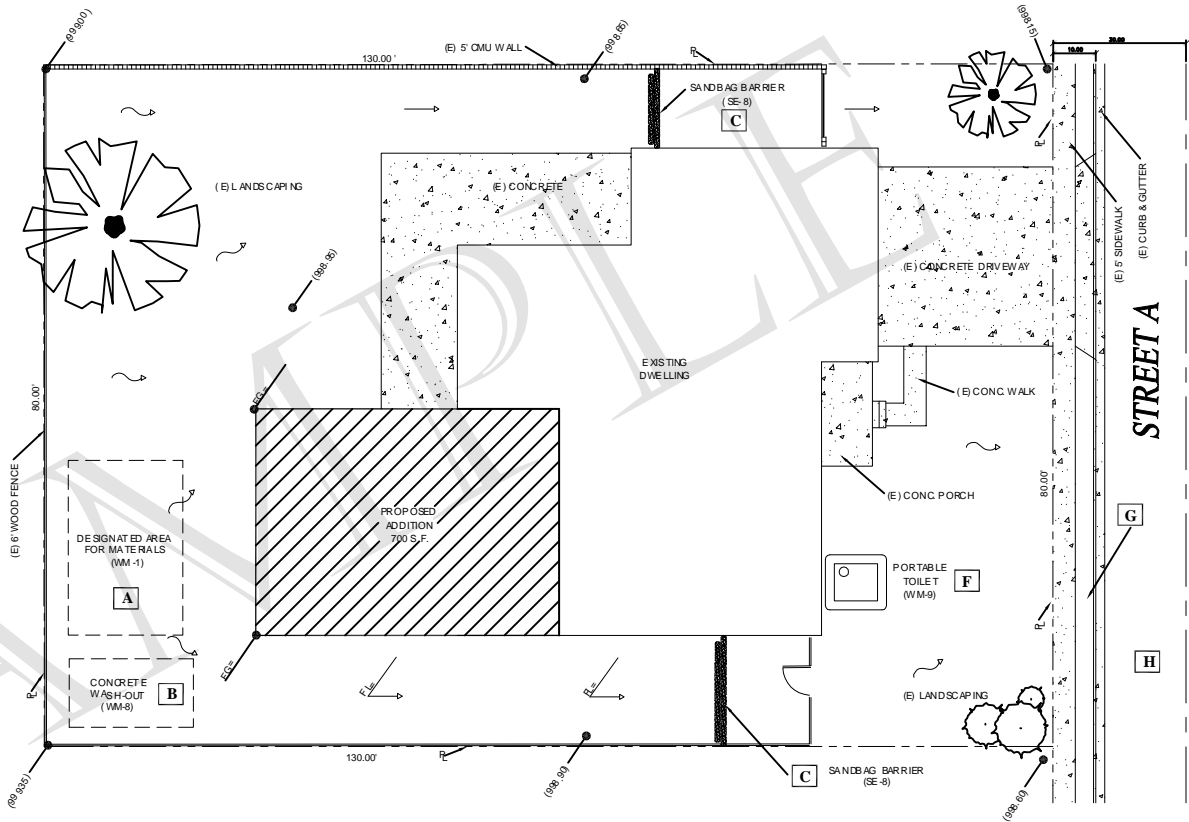

S.W.P.P. INSPECTED & APPROVED

Signature \_\_\_\_\_ Date \_\_\_\_\_

I do hereby certify under penalty of law that this document and all attachments will be carried out under my direction and supervision. I understand that at the conclusion of this project, I will be required to submit certification that all elements of this project were carried out in accordance with this SWPPP (and all attachments). In case of emergency or SWPPP corrections contact:

Name: \_\_\_\_\_ Date: \_\_\_\_\_

Title: \_\_\_\_\_ Phone: \_\_\_\_\_

CITY OF GLEN DORA		Engineering Division
DRAINAGE / S.W.P.P.P. ADDRESS		
Reviewed by:	Plan No.:	Scale: No Scale
Engineering Division	Date	Drawn By:
	Sheet 1 of 1	File No.: